



major work environment build
1000 E. 10th Street, Suite 100
Salt Lake City, UT 84103

GENERAL NOTES - REFERENCE PLANS

1. ALL WORK SHALL BE IN ACCORDANCE WITH THE LATEST EDITIONS OF THE UTAH BUILDING CODE AND ALL APPLICABLE LOCAL ORDINANCES.
2. ALL WORK SHALL BE IN ACCORDANCE WITH THE LATEST EDITIONS OF THE UTAH ELECTRICAL CODE AND ALL APPLICABLE LOCAL ORDINANCES.
3. ALL WORK SHALL BE IN ACCORDANCE WITH THE LATEST EDITIONS OF THE UTAH MECHANICAL CODE AND ALL APPLICABLE LOCAL ORDINANCES.
4. ALL WORK SHALL BE IN ACCORDANCE WITH THE LATEST EDITIONS OF THE UTAH PLUMBING CODE AND ALL APPLICABLE LOCAL ORDINANCES.
5. ALL WORK SHALL BE IN ACCORDANCE WITH THE LATEST EDITIONS OF THE UTAH FIRE CODE AND ALL APPLICABLE LOCAL ORDINANCES.
6. ALL WORK SHALL BE IN ACCORDANCE WITH THE LATEST EDITIONS OF THE UTAH SAFETY CODE AND ALL APPLICABLE LOCAL ORDINANCES.
7. ALL WORK SHALL BE IN ACCORDANCE WITH THE LATEST EDITIONS OF THE UTAH HEALTH CODE AND ALL APPLICABLE LOCAL ORDINANCES.
8. ALL WORK SHALL BE IN ACCORDANCE WITH THE LATEST EDITIONS OF THE UTAH ENVIRONMENTAL CODE AND ALL APPLICABLE LOCAL ORDINANCES.
9. ALL WORK SHALL BE IN ACCORDANCE WITH THE LATEST EDITIONS OF THE UTAH TRANSPORTATION CODE AND ALL APPLICABLE LOCAL ORDINANCES.
10. ALL WORK SHALL BE IN ACCORDANCE WITH THE LATEST EDITIONS OF THE UTAH AGRICULTURE CODE AND ALL APPLICABLE LOCAL ORDINANCES.
11. ALL WORK SHALL BE IN ACCORDANCE WITH THE LATEST EDITIONS OF THE UTAH MINING CODE AND ALL APPLICABLE LOCAL ORDINANCES.
12. ALL WORK SHALL BE IN ACCORDANCE WITH THE LATEST EDITIONS OF THE UTAH ENERGY CODE AND ALL APPLICABLE LOCAL ORDINANCES.
13. ALL WORK SHALL BE IN ACCORDANCE WITH THE LATEST EDITIONS OF THE UTAH WATER CODE AND ALL APPLICABLE LOCAL ORDINANCES.
14. ALL WORK SHALL BE IN ACCORDANCE WITH THE LATEST EDITIONS OF THE UTAH AIR CODE AND ALL APPLICABLE LOCAL ORDINANCES.
15. ALL WORK SHALL BE IN ACCORDANCE WITH THE LATEST EDITIONS OF THE UTAH LAND USE CODE AND ALL APPLICABLE LOCAL ORDINANCES.

SEE PLAN
OR PROPERTY

500 S

500 W

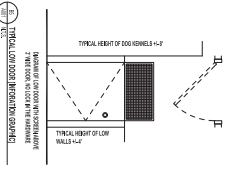
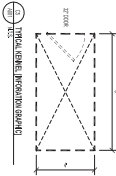
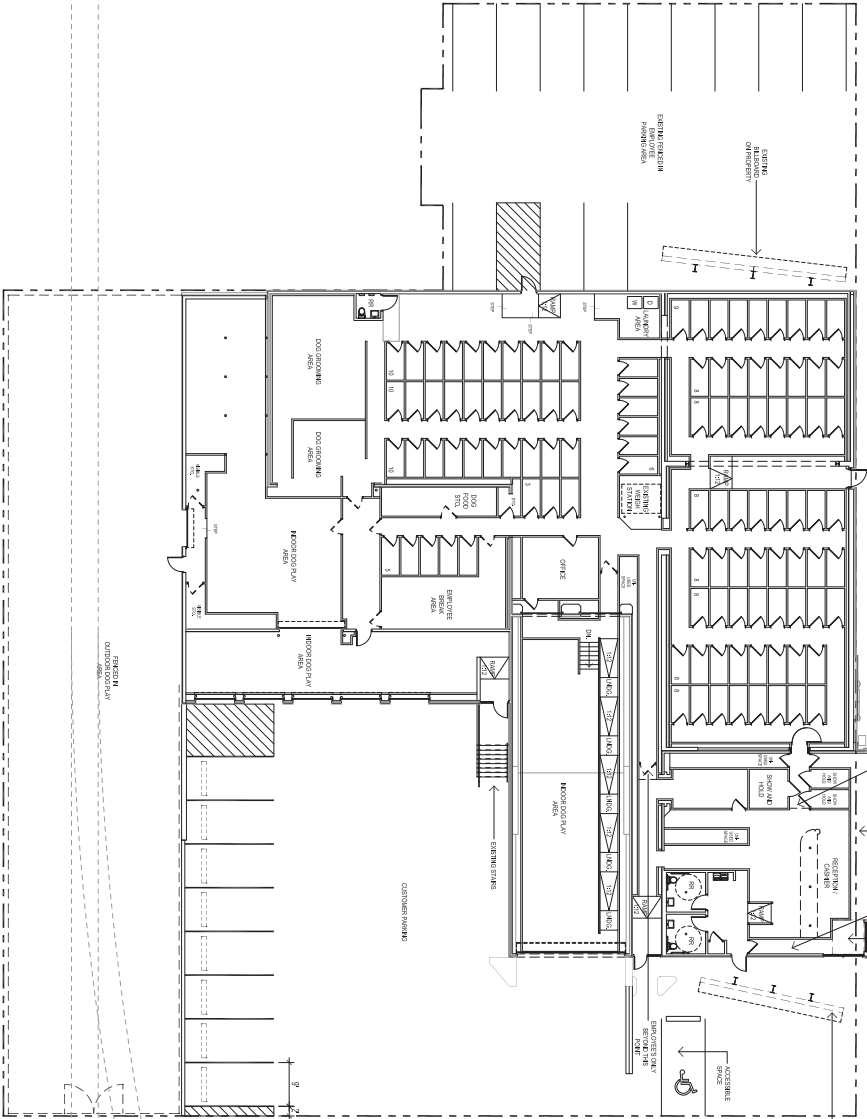

DATE REVISION



THE PERFECT WAG
505 W 500 S
Salt Lake City, UT 84101
DRAWING ISSUE: 001
DATE: 05/14/24
ISSUE: 001
PROJECT: HWL PROJECT

TEENANT FLOOR PLAN
LAYOUT AND USES WITHIN

A001

A 11

12

13

14

15